

Assembly Instructions

KC-MC Component Kit

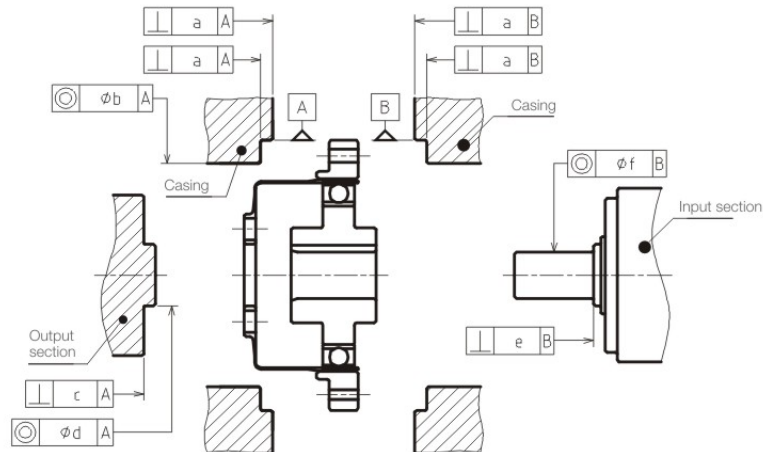

KC-MC

[mm]

Size	14	17	20	25	32
a	0.015	0.015	0.018	0.018	0.023
b	0.016	0.020	0.020	0.024	0.024
c	0.010	0.012	0.014	0.016	0.020
d	0.013	0.013	0.015	0.018	0.020
e	0.012	0.012	0.014	0.016	0.016
f	0.016	0.020	0.024	0.024	0.024

KSB Simplicity box

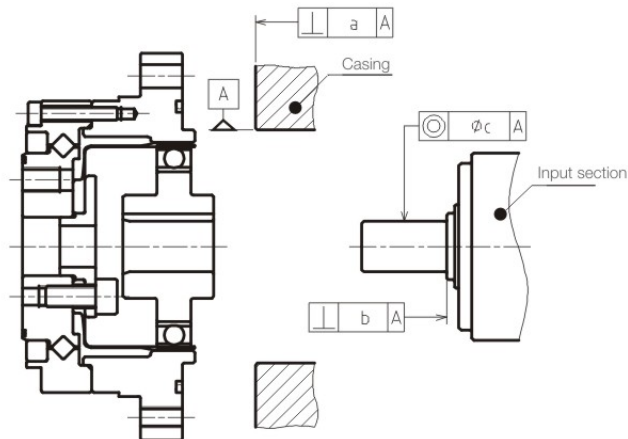

KSB Simplicity box

[mm]

Size	14	17	20	25	32
a	0.020	0.020	0.020	0.025	0.025
b	0.012	0.012	0.014	0.016	0.016
c	0.016	0.020	0.024	0.024	0.024

KB Box Unit

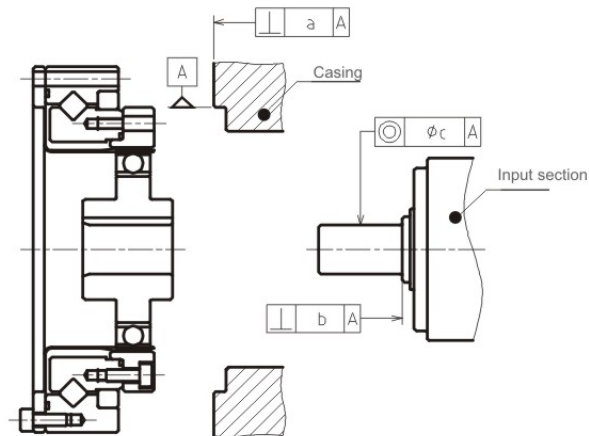

KB Box Unit						[mm]
Size	14	17	20	25	32	
a	0.020	0.020	0.020	0.025	0.025	
b	0.012	0.012	0.014	0.016	0.016	
c	0.016	0.020	0.024	0.024	0.024	

Caution During Installation

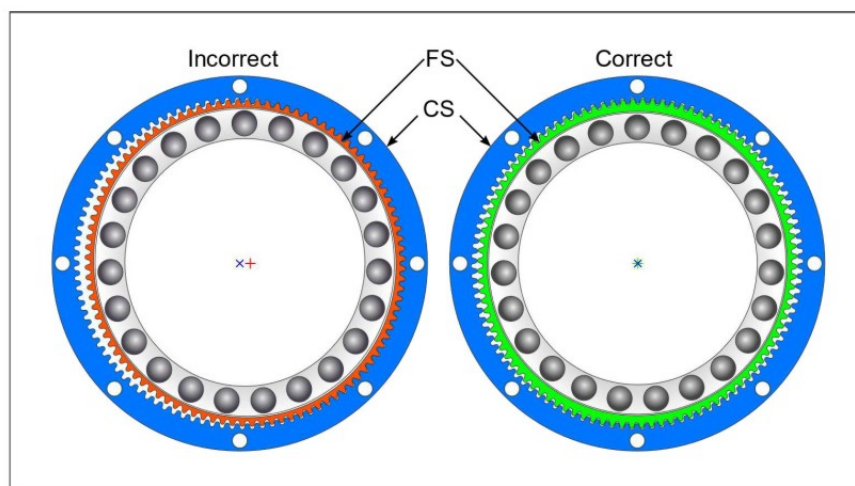

Bei der Montage des Getriebes ist darauf zu Achten, dass der FS mittig im CS sitzt. Es kann passieren, dass der FS auf einer Seite einen Zahn überspringt.

Man spricht hierbei vom sogenannten Dedoidal. Hierbei kann es zu einer Vielzahl von Problemen bis hin zum Ausfall des gesamten Getriebes kommen.

When installing the gearbox, make sure that the FS is seated in the center of the CS. It can happen that the FS skips a tooth on one side. This is called the so-called dedoidal. This can lead to a variety of problems, including failure of the entire transmission.

Motor Installation Procedure

Procedure 1

- Attach the flange on to the motor
- Attach the cam with elastic bearings to the motor shaft
- Attach the unit

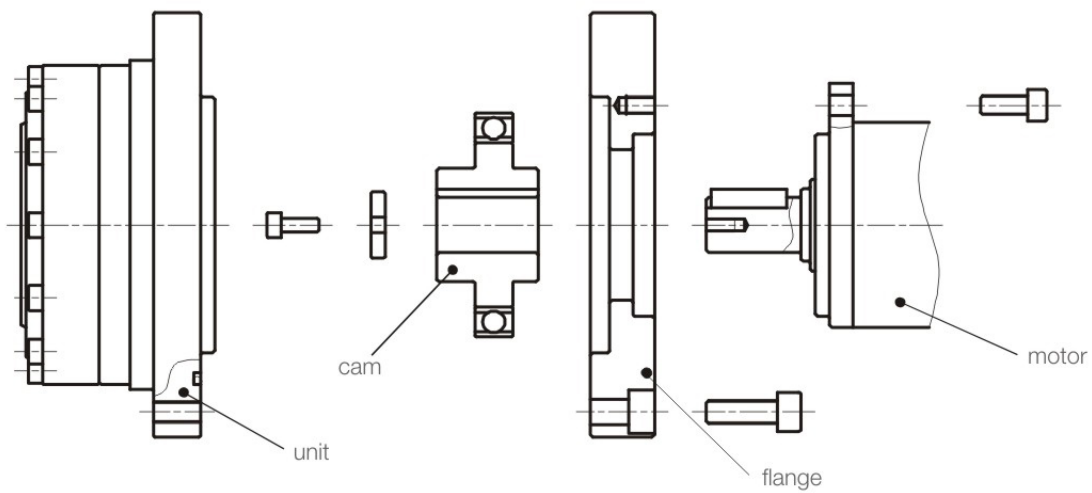

Procedure 2

- Attach the cam with elastic bearings to the motor shaft
- Attach the flange on to the motor
- Attach the unit

